

SILCA NEWS

ALL THE NEW KEYS, AUTOMOTIVE SOLUTIONS, KEY CUTTING MACHINES, SOFTWARE UPDATES AND MUCH MORE

2024
OCTOBER

NR.
10









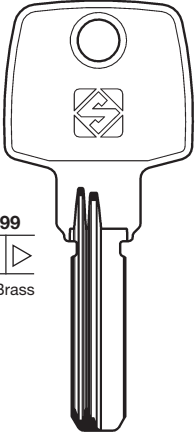

PROFILE Reader
Vers. 2.0

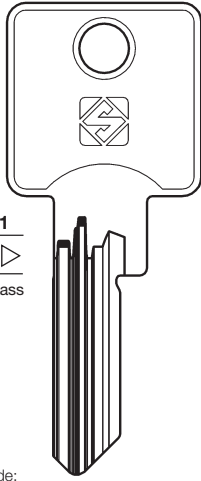
NETWORK WITH US

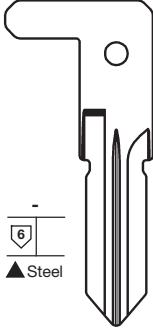

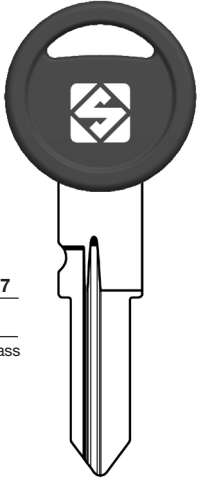
Silca key blanks are compatible with third party manufacturers' cylinders specified here below. Concerning the trademarks and tradenames, please see legal note on the final page.

NIMLY	TOK-WINKHAUS	VACHETTE	
 <p>999 ● Brass</p>  <p>NLY1R</p>  <p>8 052782 048741 Box of 50</p>	 <p>471 ● Brass</p> <p>Orig. code: E150</p>  <p>TO136</p>  <p>8 052782 049199 Box of 50</p>	 <p>▲ Steel</p>  <p>VAC102T</p>  <p>8 052782 049533 Box of 50</p>	<p>NIMLY (MA)</p> <p>TOK-WINKHAUS (DE)</p> <p>VACHETTE (FR)</p> <p>ZADI (IT)</p>
ZADI			
 <p>P527 ● Brass</p>  <p>ZD41RLP</p>  <p>8 052782 050317 Box of 25</p>			<ul style="list-style-type: none"> ● Brass/Ottone/Messing/Laiton/Latón/Latão ▲ Steel/Acciaio/Stahl/Acier/Acero/Aço ■ Nickel silver/Alpacca Neusilber/Maillechort Alpaca/Alpaca ◆ Iron/Ferro/Eisen/Fer/Hierro/Ferro <p> ⊙ Color ⊙ Silky ⊙ Ultralite ⊙ Taggy </p>

Silca Slot Car Key VA150S24 compatible with Renault*

🇬🇧 New Slot Key

Silca is pleased to introduce a new reference for duplicating 2012-2019 Renault Zoe slot keys. The key features four function buttons (lock, unlock, air conditioning, charging cord release / flap open) and can be programmed with Smart Pro.

🇮🇹 Nuova Chiave Slot

Silca presenta una nuova referenza per la duplicazione delle chiavi di prossimità compatibile con la Renault Zoe. La chiave è dotata di quattro pulsanti (apertura e chiusura centralizzata delle portiere, sblocco del cavo di carica/apertura dello sportello di ricarica, attivazione dell'aria condizionata).

🇩🇪 Neuer Slot-Schlüssel

Silca präsentiert eine neue Referenz zum Kopieren von Keyless-Go-Schlüsseln, die mit dem Renault Zoe kompatibel sind. Der Schlüssel hat vier Tasten (Zentralöffnung und Verriegelung der Türen, entriegelung des Ladekabels/Öffnen des Ladeanschlusses, aktivierung der Klimaanlage).

🇫🇷 Nouvelle Clé Slot

Silca présente un nouvel article pour reproduire des clés de proximité compatibles avec Renault Zoe. La clé a 4 boutons (déverrouillage et verrouillage centralisé des portières, activation du conditionnement d'air, déverrouillage du cordon de charge/ouverture de la trappe de charge).

🇵🇹 Nova Chave Slot

A Silca apresenta uma nova referência para a duplicação de chaves de proximidade compatíveis com Renault Zoe. A chave tem quatro botões (Destrancamento das portas e do porta-bagagens, trancamento das portas e do portabagagens, desbloqueio do cabo de carga/abertura da tampa de carga, ativação do ar condicionado).

🇪🇸 Nueva Llave de inserción

Silca presenta una nueva referencia para la duplicación de llaves de proximidad compatibles con Renault Zoe. La llave tiene cuatro botones (Desbloqueo de las puertas y del maletero, bloqueo de las puertas y del maletero, desbloqueo del cable de carga / apertura de la tapa de carga, activación del aire acondicionado).

CE The Silca Proximity Car Key VA150S24 has been produced in conformity with CE mark European standards.



VA150S24

Emergency blade VA150



Application list for VA150S24

Make	Model	Chassis	From	To	Buttons	Trp ID	Frequency
Renault	Zoe	X10	2012	2019	4	46	433FM

See the full range of Silca car remotes in the October update of the catalogue available at silca.biz



> More info at mykeyspro.com

* This is a trademark of a third party not affiliated nor linked with Silca S.p.A. or the dormakaba Group. Silca S.p.A. and dormakaba Group do not own any intellectual property right nor have been granted any license with regard to such trademark, which is hereby used only to indicate the intended purpose of Silca's products.

Silca Slot Car Key HU188S25 compatible with Land Rover*

Replaceable battery included

🇬🇧 New Slot Key

Silca is pleased to introduce a new reference for duplicating 2006-2012 Freelander slot keys. The key features five function buttons (lock, unlock, boot release, lights and hazard lights) and can be programmed with Smart Pro.

🇮🇹 Nuova Chiave Slot con batteria sostituibile inclusa

Silca presenta una nuova referenza per la duplicazione delle chiavi di prossimità compatibile con la Land Rover Freelander. È dotata di cinque pulsanti (apertura/chiusura centralizzata delle portiere, apertura del bagagliaio, luci e quattro frecce).

🇪🇸 Neuer Slot-Schlüssel mit Auswechselbarer Akku inklusive

Silca präsentiert eine neue Referenz zum Kopieren von Keyless-Go-Schlüsseln, die mit dem Land Rover Freelander kompatibel sind. Der Schlüssel hat fünf Tasten (Zentralöffnung/-verriegelung der Türen, Gepäckraumöffnung, Licht und Warnblinker).

🇫🇷 Nouvelle Clé Slot avec batterie remplaçable incluse

Silca présente un nouvel article pour reproduire des clés de proximité compatibles avec Land Rover Freelander. Elle a cinq boutons (déverrouillage/verrouillage centralisé des por-tières, ouverture du coffre, phares et feux de détresse).

🇵🇹 Nova Chave Slot com bateria substituível incluída

A Silca apresenta uma nova referência para a duplicação de chaves de proximidade compatíveis com Land Rover Freelander. A chave tem cinco botões (abertura/ fecho centralizado das por-tas, abertura da bagageira, farol e luz de emergência).

🇪🇸 Nueva Llave de inserción con batería reemplazable incluida

Silca presenta una nueva referencia para la duplicación de llaves de proximidad compatibles con Land Rover Freelander. La llave tiene cinco botones (apertura/cierre centralizados de las puertas, apertura del maletero, faros y luz de emergencia).

CE The Silca Slot Car Key HU188S25 has been produced in conformity with CE mark European standards.



HU188S25

Emergency key HU101

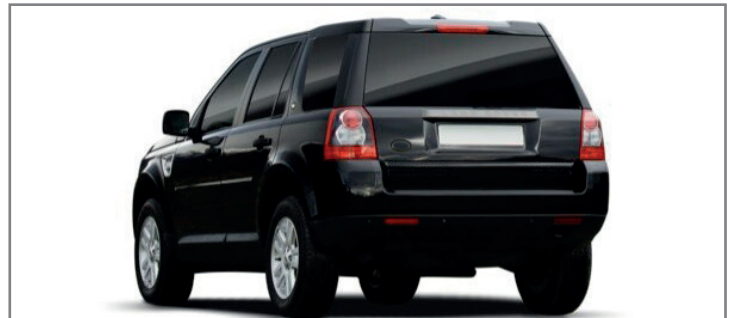

Application list for HU188S25

Make*	Model	Chassis	From	To	Buttons	Trp ID	Frequency	Silca profile
Land Rover	Freelander 2	L359	2006	2012	5	46	433AM	HU101

See the full range of Silca car remotes in the October update of the catalogue available at silca.biz



> More info at mykeyspro.com

* This is a trademark of a third party not affiliated nor linked with Silca S.p.A. or the dormakaba Group. Silca S.p.A. and dormakaba Group do not own any intellectual property right nor have been granted any license with regard to such trademark, which is hereby used only to indicate the intended purpose of Silca's products.

Key Programming Software Update compatible with Fiat* ADS2327 - Code D756606AD

Now programmes keys for Iveco and Maserati



 The updated ADS2327 software now programmes keys for models including the Iveco Daily, Alfa Romeo Stelvio and Maserati Quattroporte as well as other popular models from Fiat, Alfa Romeo, Citroën, Peugeot and Opel even in an all keys lost situation.

 **Ora programma le chiavi per Iveco e Maserati.**

Advanced Diagnostics ha sviluppato un aggiornamento software per la programmazione delle chiavi di modelli importante da Fiat*, Alfa Romeo, Citroën, Iveco, Maserati Peugeot e Opel.

 **Jetzt programmiert Schlüssel für Iveco und Maserati.**

Advanced Diagnostics hat ein Update der Programmiersoftware für die wichtigsten Modelle von Fiat, Alfa Romeo, Citroën, Iveco, Maserati, Peugeot und Opel.

 **Programme désormais les clés pour Iveco et Maserati.**

Advanced Diagnostics annonce une mise à jour solution de programmation des clés pour les véhicules important des marques Fiat, Alfa Romeo, Citroën, Iveco, Maserati, Peugeot et Opel.

 **Agora programa chaves para Iveco e Maserati.**

A Advanced Diagnostics desenvolveu uma importante atualização de software de programação para os principais modelos de Fiat, Alfa Romeo, Citroën, Iveco, Maserati, Peugeot e Opel.

 **Ahora programa llaves para Iveco y Maserati.**

Advanced Diagnostics ha desarrollado una actualización de software de programación llaves para los principales modelos de Fiat, Alfa Romeo, Citroën, Iveco, Maserati, Peugeot y Opel.



What else is needed?



Smart Pro



Cable ADC2019
(certain applications only)



SIP22R34



GT21P27

OFFER DETAILS

Cable	ADC2000
Smart Aerial/Smart Aerial+ required	Yes
Software category	A
Other accessories required	ADC2019 (certain applications only)

> More info at mykeyspro.com

* This is a trademark of a third party not affiliated nor linked with Silca S.p.A. or the dormakaba Group. Silca S.p.A. and dormakaba Group do not own any intellectual property right nor have been granted any license with regard to such trademark, which is hereby used only to indicate the intended purpose of Silca's products.

Software Applications

Fiat* ADS2327 Code D756606AD

 *	KEY TYPE								
Alfa Romeo Giulia 2018 --> 2024	Proximity	✓	✓	✓	ADC2000	ADC2019	✗	49-1E	GT21P27
Alfa Romeo Stelvio 2018 --> 2024	Proximity	✓	✓	✓	ADC2000	ADC2019	✗	49-1E	GT21P27
Chrysler Ypsilon Hybrid 2021 --> 2024	Bladed	✓	✓	✓	ADC2000		✗	ID46	SIP22R34
Citroën Jumper 2012 --> 2017	Bladed	✓	✓	✓	ADC2000		✗	ID46	SIP22R34
Citroën Relay 2015 --> 2024	Bladed	✓	✓	✓	ADC2000		✗	ID46	SIP22R34
Fiat 500 Hybrid 2020 --> 2024	Bladed	✓	✓	✓	ADC2000		✗	ID46	SIP22R34
Fiat Ducato 2015 --> 2021	Bladed	✓	✓	✓	ADC2000		✗	ID46	SIP22R34
Fiat Panda Hybrid 2020 --> 2024	Bladed	✓	✓	✓	ADC2000		✗	ID46	SIP22R34
Iveco Daily 2014 --> 2019	Bladed	✓	✓	✓	ADC2000		✗	ID46	SIP22R34
Lancia Ypsilon Hybrid 2020 --> 2023	Bladed	✓	✓	✓	ADC2000		✗	ID46	SIP22R34
Maserati Gran Turismo 2007 --> 2012	Bladed	✓	✓	✓	ADC2000		✗	ID48	SIP22TE
Maserati Quattroporte 2004 --> 2012	Bladed	✓	✓	✓	ADC2000		✗	ID48	SIP22TE
Opel-Vauxhall Movano 2020 --> 2024	Bladed	✓	✓	✓	ADC2000		✗	ID46	SIP22R34
Peugeot Boxer 2015 --> 2020	Bladed	✓	✓	✓	ADC2000		✗	ID46	SIP22R34



> More info at mykeyspro.com

* This is a trademark of a third party not affiliated nor linked with Silca S.p.A. or the dormakaba Group. Silca S.p.A. and dormakaba Group do not own any intellectual property right nor have been granted any license with regard to such trademark, which is hereby used only to indicate the intended purpose of Silca's products.



Data update with new vehicle applications / Aggiornamento dati con nuove applicazioni veicolo / Datenaktualisierung mit neuen Fahrzeug-Anwendungen / Mise à jour des données avec des nouvelles applications de véhicules / Actualización de datos con nuevas aplicaciones de vehículos / Atualização de dados com novas aplicações de veículos

*Silca Advanced Diagnostics software to program car keys compatible with third party makes and models. Concerning the trademarks and tradenames, please see legal note on the final page.

REGION	MAKE*	MODEL	YEAR START	YEAR END	KEY TYPE	SW MODULE
Europe	Opel-Vauxhall	Ampera	2017	2019	PROX	ADS2279
Europe	Suzuki	Across	2022	2024	PROX	ADS2328
Asia	Peugeot	308	2013	2020	PROX	ADS2188
Asia	Hino	Ranger	2012	2024	BLADE	ADS2125
Asia	Jeep	Cherokee	2008	2012	BLADE	ADS2156
Asia	Mazda	3	2019	2024	PROX	ADS2322
Asia	Nissan	X-Trail	2014	2021	BLADED	ADS2197
Asia	Toyota	Corolla	2019	2022	PROX	ADS2328
Australia	Lexus	LX500d	2021	2024	PROX	ADS2328
Australia	Toyota	Kluger	2022	2024	PROX	ADS2328
Australia	Suzuki	Alto	2015	2020	PROX	ADS2233
New Zealand	Kia	Carnival	2020	2023	PROX	ADS2321
USA	Hyundai	Elantra	2022	2023	BLADED	ADS2280
USA	Hyundai	Kona	2023	2023	BLADED	ADS2196
USA	Kia	K5	2022	2022	BLADED	ADS2280
USA	Hyundai	Ioniq6	2023	2024	PROX	ADS2321
USA	Toyota	Tacoma	2024	2024	PROX	ADS2328
USA	Cadillac	XT4	2019	2019	PROX	ADS2279

> More info at mykeyspro.com



NEW MOBILE APP SOFTWARE VERSION

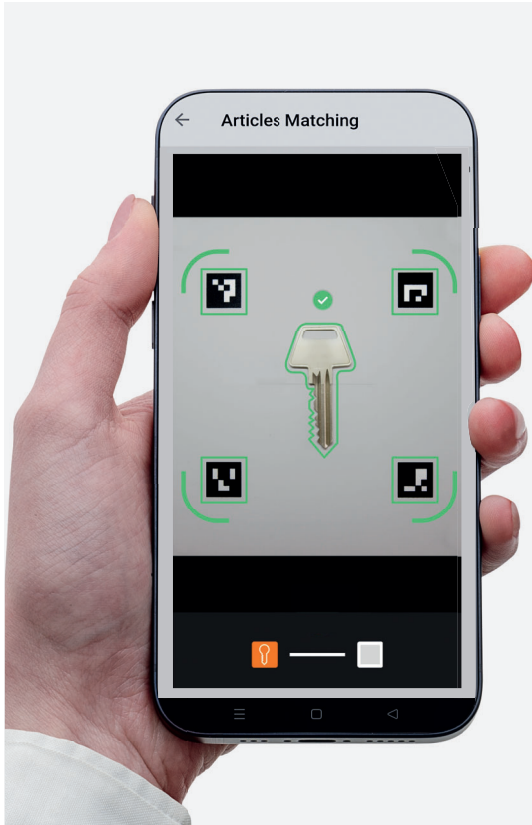

PROFILE Reader

KEY PROFILE IMMEDIATE RECOGNITION

Funzionalità autoscatto immediato del profilo della chiave / Sofortige Erkennung des Schlüsselprofils / Reconnaissance immédiate du profil clé / Reconocimiento inmediato del perfil llave / Reconhecimento imediato do perfil chave.

NEW

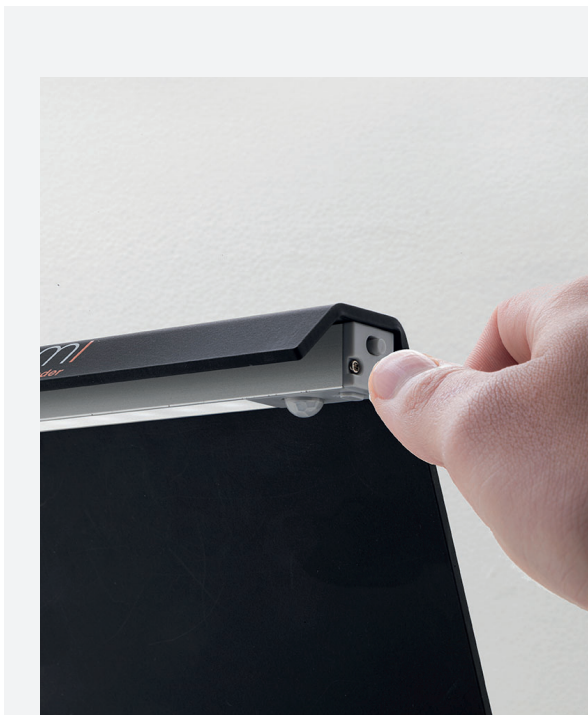

LUMI PROFILE Reader

NEW LAMP AVAILABLE WITH ON/OFF SWITCH AND MOTION SENSOR

Nuova lampada con interruttore ON/OFF e sensore di movimento / Neue Lampe mit ON/AUS-Schalter und Bewegungssensor / Nouvelle lampe avec interrupteur ON/OFF et détecteur de mouvement / Lámpara nueva con interruptor ON/OFF y sensor de movimiento / Nova lâmpada com interruptor ON/OFF e sensor de movimento

NEW



FUTURA PRO Software Vers. 3.49.0 DB 12.05 - Silca App. Vers. 3.0

NEW SYSTEMS

LOCK MANUFACTURER*	LOCK SYSTEMS*	PROFILE	SERIES	SN	DATA CARD	CLAMP
BASI - DOM 	Basi SPK (Prf. 161)	-	-	1444	3695	01R-01J-02J
KESO	Keso K1000 (5 Axis)	-	-	2523	5555	01R-26J-27J
KESO	Keso K1000S (5 Axis)	-	-	2521	5553	01R-26J-27J
KESO	Keso K1000S Step drilling (4 Axis)	-	-	2522	5554	01R-26J-27J
KESO	Keso K2000S (3mm) Step drilling (4 Axis)	-	-	2520	5552	01R-01J-02J
KESO	Keso K2000S (5mm) Step drilling (4 Axis)	-	-	2519	5549	01R-01J-02J
KESO	Keso K3000 Step drilling (4 Axis)	-	-	2512	5548	01R-26J-27J
KIA	EV9	MV....	0001-2254	2518	3911	01R-01J-02J- 01R-106-107
MOLLOCK - ICSA	217/M	1234567	10035	5550	01V
TARONI	SERIE 2.2	501001-501648	2517	4504	01R-01J-02J
TARONI	SERIE 3D NEXT 5P	5N....	0001-2074	2513	5066	01R-01J-02J
TARONI	SERIE 3D NEXT 6P	6N....	00001-12678	2514	5066	01R-01J-02J
TARONI	SERIE 3S NEXT 5P	5N....	0001-2074	2515	5067	01R-01J-02J
TARONI	SERIE 3S NEXT 6P	6N....	00001-12678	2516	5067	01R-01J-02J

(*) This is a trademark of a third party not affiliated nor linked with Silca S.p.A. or the dormakaba Group. Silca S.p.A. and dormakaba Group do not own any intellectual property right nor have been granted any license with regard to such trademark, which is hereby used only to indicate the intended purpose of Silca's products.

> More info on [all Silca websites](#)



LEGAL NOTES - In compliance with current regulations relating to industrial property, please note that – but for “Silca”, “dormakaba”, “Kaba”, “Ilco” and “Advanced Diagnostics” – the trademarks or trade names mentioned in our document are the exclusive property of third parties not affiliated nor linked with Silca S.p.A. or the dormakaba Group. Silca S.p.A. and dormakaba Group do not own any intellectual property right nor have been granted any license with regard to such trademarks and trade names, which are hereby used only to indicate the intended purpose of Silca’s products. This catalogue is reserved exclusively for professional key cutters who use Silca products. The illustrations and technical data regarding the products in the document are to be considered indicative. Silca reserves the right to alter products designs, dimensions or info to improve the products quality. The contents of this document are fully protected by Copyright and may not be copied or reproduced in any form, without written permission from Silca S.p.A. For any dispute the competent Court is that of Treviso, the applicable law is that of Italy.

NOTE LEGALI - In ottemperanza alla normativa vigente in materia di proprietà industriale, si ricorda che – fatta eccezione per “Silca”, “dormakaba”, “Kaba”, “Ilco” e “Advanced Diagnostics” – i marchi o i nomi commerciali citati nel nostro documento sono di esclusiva proprietà di terzi, non affiliati né collegati a Silca S.p.A. o al Gruppo dormakaba. Silca S.p.A. e il Gruppo dormakaba non possiedono alcun diritto di proprietà intellettuale né agli stessi è stata concessa alcuna licenza in relazione a detti marchi o denominazioni commerciali, i quali sono qui citati solo per indicare la destinazione d’uso dei prodotti Silca. Questo catalogo è riservato esclusivamente ai duplicatori professionisti che utilizzano i prodotti Silca. Le illustrazioni e i dati tecnici dei prodotti contenuti nel documento sono puramente indicativi. Silca si riserva il diritto, ferme restando le caratteristiche essenziali dei prodotti, di apportare tutte le modifiche che ritiene necessarie e opportune al fine di migliorare la qualità dei prodotti. Tutti i disegni e le fotografie sono di proprietà di Silca, ogni riproduzione anche parziale, senza autorizzazione scritta di Silca S.p.A., è vietata secondo termini di legge. Per qualsiasi controversia il foro competente è quello di Treviso, la legge vigente è quella italiana.

RECHTLICHE HINWEISE - In Übereinstimmung mit den geltenden Bestimmungen zum gewerblichen Eigentum weisen wir darauf hin, dass – mit Ausnahme von “Silca”, “dormakaba”, “Kaba”, “Ilco” und “Advanced Diagnostics” – die in unserem Dokument erwähnten Markenzeichen oder Handelsnamen das ausschließliche Eigentum Dritter sind, die weder der Silca S.p.A. noch der dormakaba Gruppe angehören oder mit diesen verbunden sind. Diese Markenzeichen oder Handelsbezeichnungen werden hier nur erwähnt, um auf die bestimmungsgemäße Verwendung der Silca-Produkte hinzuweisen. Dieser Katalog ist ausschließlich professionellen Schlüsseldiensten vorbehalten, die Silca-Produkte verwenden. Die in diesem Dokument enthaltenen Abbildungen und technischen Daten der Produkte sind als Richtwerte zu betrachten. Silca behält sich vor, etwaige Änderungen, die zur Verbesserung des Produktes beitragen, vorzunehmen. Alle Zeichnungen und Fotos sind Eigentum der Firma Silca. Jede Reproduktion, auch teilweise, ist ohne ausdrückliche Genehmigung der Silca S.p.A. gesetzlich untersagt. Für alle Streitigkeiten ist das Gericht von Treviso zuständig, das geltende Recht ist italienisch.



MENTIONS LÉGALES - Conformément à la législation en vigueur en matière de propriété industrielle, il est rappelé que – à l’exception de “Silca”, “dormakaba”, “Kaba”, “Ilco” et “Advanced Diagnostics” – les marques ou noms commerciaux mentionnés dans notre document sont la propriété exclusive de tiers, non affiliés, ni liés à Silca S.p.A. ou au Groupe dormakaba. Ces marques ou dénominations commerciales ne sont mentionnées ici que pour indiquer la destination des produits Silca. Ce catalogue est exclusivement réservé aux reproducteurs professionnels qui utilisent les produits Silca. Les illustrations et les données techniques des produits contenus dans le document doivent être considérées comme indicatives. Bien que les caractéristiques essentielles des produits soient invariables, Silca se réserve le droit d’apporter toutes les modifications qu’elle retiendra nécessaires et opportunes afin d’améliorer la qualité de ses produits. Tous les dessins et photos sont propriété Silca et toute reproduction, même partielle, sans l’autorisation écrite préalable de Silca S.p.A. est interdite conformément aux prescriptions légales. Pour tout litige, le tribunal compétent est celui de Trévise, la loi en vigueur est italienne.

AVISOS LEGALES - En cumplimiento de la normativa vigente en materia de propiedad industrial, se recuerda que – salvo para “Silca”, “dormakaba”, “Kaba”, “Ilco” y “Advanced Diagnostics” – las marcas y los nombres comerciales citados en nuestro documento son propiedad exclusiva de terceras sociedades, no afiliadas ni asociadas con Silca S.p.A. o el Grupo dormakaba. Dichas marcas o denominaciones comerciales se citan aquí solamente para indicar el empleo de destino de los productos Silca. Este catálogo queda reservado exclusivamente a los duplicado-res profesionales, que utilizan los productos Silca. Las ilustraciones y los datos técnicos de los productos contenidos en el documento se han de considerar indicativos. Silca se reserva el derecho, quedando invariables las características principales de los productos, de modificar todo lo que considere necesario y oportuno para mejorar la calidad de sus artículos. Todos los dibujos y fotografías pertenecen a Silca; según determina la Ley, se prohíbe toda reproducción, total o parcial, sin autorización por escrito de Silca S.p.A. Para cualquier litigio el tribunal competente es el de Treviso, la ley vigente es la italiana.

NOTÍCIAS LEGAIS - No respeito das normas em vigor relativas à propriedade industrial, lembrese que – exceptuando “Silca”, “dormakaba”, “Kaba”, “Ilco” e “Advanced Diagnostics” – as marcas ou os nomes comerciais citados no nosso documento são propriedade exclusiva de terceiros, não associados nem ligados à Silca S.p.A. ou ao Grupo dormakaba. Essas marcas ou denominações comerciais são citadas aqui somente para indicar o uso pretendido dos produtos Silca. Este catálogo é reservado exclusivamente aos profissionais da duplicação que utilizam os produtos Silca. As figuras e as características técnicas dos produtos contidas no documento são facultadas a título indicativo. Mesmo que as características essenciais dos produtos sejam invariáveis, à Silca reserva-se o direito de modificar ser necessário e oportuno los productos, afim de melhorar a sua qualidade. Todos os desenhos e fotos são propriedade da Silca, e é proibida a sua reprodução mesmo parcial sem a autorização escrita da Silca S.p.A. conforme as prescrições legais. Para qualquer litígio o tribunal competente é o de Treviso, a lei vigente é a italiana.